

COPPER TUBE CRIMPING LUGS

for copper conductors



File no. E125401

A-M

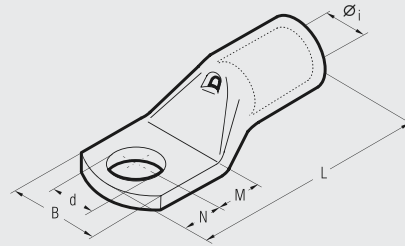

A-M series lugs are manufactured from electrolytic copper tube.

The dimensions of the tube are designed to obtain the most efficient electrical conductivity and mechanical strength to resist vibration and pull out.

Cembre lugs are annealed to guarantee optimum ductility which is an absolute necessity for connectors which will have to withstand the severe deformation arising when compressed and any bending of the palm during installation.

In applications subject to vibration, lugs still have to provide a reliable connection and annealing plays a vital role in avoiding cracking or breaks between the barrel and palm.

The presence of an inspection hole facilitates full insertion of the conductor; whilst the barrel length has been designed to allow easy and accurate positioning of the dies during the crimping operation.

Lugs are electrolytically tinned to avoid oxidation. A-M series lugs form an important part of Cembre crimping systems for power carrying conductors, details of the appropriate crimping tools and dies are shown opposite and in detail on pages 160 to 167. Our technicians are always available to provide any technical advice which may be required.

The enclosed table is only indicative of the range and many variations in stud fixing and palm lengths are also available.

Cond. Size sqmm <small>low stranded flexible*</small>	Ø Stud mm	Ref.	Dimensions mm							Quantity Box/Bag	Mechanical Tools	Hydraulic Tools
			Øi	B	M	N	L	d				
0,25÷1,5	3	A 03-M 3	1,8	6,0	4,5	3,5	16,0	3,2	5.000/100	HN 1	B 150	
	3,5	A 03-M 3.5	1,8	6,5	4,5	3,5	16,0	3,7	5.000/100			
	4	A 03-M 4	1,8	6,5	5,0	4,0	17,0	4,3	5.000/100			
	5	A 03-M 5	1,8	7,5	5,5	4,5	18,0	5,3	5.000/100			
1,5÷2,5	6	A 03-M 6	1,8	9,0	6,0	5,0	19,0	6,4	5.000/100			
	3	A 06-M 3	2,4	6,0	4,5	3,5	17,0	3,2	4.000/100			
	3,5	A 06-M 3.5	2,4	6,5	4,5	3,5	17,0	3,7	4.000/100			
	4	A 06-M 4	2,4	7,5	5,0	4,0	18,0	4,3	4.000/100			
4÷6	5	A 06-M 5	2,4	8,5	5,5	4,5	19,0	5,3	4.000/100			
	6	A 06-M 6	2,4	9,0	6,0	5,0	20,0	6,4	4.000/100			
	8	A 06-M 8	2,4	12,0	9,0	8,0	26,0	8,4	2.500/100			
	3	A 1-M 3	3,6	7,5	4,5	3,5	20,5	3,2	2.000/100			
10	3,5	A 1-M 3.5	3,6	7,5	4,5	3,5	20,5	3,7	2.000/100			
	4	A 1-M 4	3,6	8,0	5,0	4,0	21,5	4,3	2.000/100			
	5	A 1-M 5	3,6	9,0	6,5	6,0	25,0	5,3	2.000/100			
	6	A 1-M 6	3,6	11,0	7,0	6,0	25,5	6,4	2.000/100			
16	8	A 1-M 8	3,6	14,0	9,0	8,0	29,5	8,4	1.500/100			
	10	A 1-M 10	3,6	16,5	11,0	10,0	33,5	10,5	1.000/100			
	4	A 2-M 4	4,6	10,0	5,0	4,0	22,5	4,3	1.500/100			
	5	A 2-M 5	4,6	10,0	6,5	6,0	26,0	5,3	1.500/100			
25	6	A 2-M 6	4,6	11,0	7,0	6,0	26,5	6,4	1.500/100			
	8	A 2-M 8	4,6	15,0	9,0	8,0	30,5	8,4	1.000/100			
	10	A 2-M 10	4,6	18,0	11,0	10,0	34,5	10,5	1.000/100			
	12	A 2-M 12	4,6	19,0	14,0	12,0	39,5	13,2	500/100			
35	4	A 3-M 4	5,8	11,5	5,0	4,0	25,5	4,3	1.000/100			
	5	A 3-M 5	5,8	11,5	6,5	6,0	29,0	5,3	1.000/100			
	6	A 3-M 6	5,8	11,5	7,0	6,0	29,5	6,4	1.000/100			
	8	A 3-M 8	5,8	15,0	9,0	8,0	33,5	8,4	500/100			
50	10	A 3-M 10	5,8	18,0	11,0	10,0	37,5	10,5	500/100			
	12	A 3-M 12	5,8	20,0	14,0	12,0	42,5	13,2	500/100			
	4	A 5-M 4	7,0	14,0	5,0	4,0	28,0	4,3	1.000/100			
	5	A 5-M 5	7,0	14,0	6,5	6,0	31,5	5,3	500/100			
70	6	A 5-M 6	7,0	14,0	7,0	6,0	32,0	6,4	500/100			
	8	A 5-M 8	7,0	15,0	9,0	8,0	36,0	8,4	500/100			
	10	A 5-M 10	7,0	18,0	11,0	10,0	40,0	10,5	500/100			
	12	A 5-M 12	7,0	21,0	14,0	12,0	45,0	13,2	500/100			
25	5	A 7-M 5	8,9	17,0	6,5	6,0	34,0	5,3	500/100			
	6	A 7-M 6	8,9	17,0	7,0	6,0	34,5	6,4	500/100			
	8	A 7-M 8	8,9	17,0	9,0	8,0	38,5	8,4	400/100			
	10	A 7-M 10	8,9	19,0	11,0	10,0	42,5	10,5	400/100			
35	12	A 7-M 12	8,9	21,0	14,0	12,0	47,5	13,2	300/50			
	6	A 10-M 6	10,0	19,0	8,0	7,0	40,5	6,4	200/50			
	8	A 10-M 8	10,0	19,0	9,0	8,0	42,5	8,4	200/50			
	10	A 10-M 10	10,0	20,0	11,0	10,0	46,5	10,5	200/50			
50	12	A 10-M 12	10,0	21,0	14,0	12,0	51,5	13,2	200/50			
	14	A 10-M 14	10,0	25,0	16,0	14,0	55,5	15,0	200/50			
	16	A 10-M 16	10,0	26,0	18,0	16,0	59,5	17,0	200/50			
	6	A 14-M 6	11,3	21,0	8,0	7,0	44,0	6,4	200/50			
70	8	A 14-M 8	11,3	21,0	9,0	8,0	46,0	8,4	200/50			
	10	A 14-M 10	11,3	21,0	11,0	10,0	50,0	10,5	200/50			
	12	A 14-M 12	11,3	22,0	14,0	12,0	55,0	13,2	150/50			
	14	A 14-M 14	11,3	25,0	16,0	14,0	59,0	15,0	100/50			
16	A 14-M 16	11,3	26,0	18,0	16,0	63,0	17,0	100/50				

WOKING

Unit 19, Woking Business Park, Albert Drive,
Woking GU21 5JY
Tel: 01483 747747 • Fax: 01483 747001

BRISTOL

The Alpha Centre, Armstrong Way, , Great Western
Business Park, Yate, Bristol BS37 5NG
Tel: 01454 322555 • Fax: 01454 323555

NORTON CANES

Unit 15-16, Bellsizes Close, Norton Canes,
Staffordshire WS11 9TQ
Tel: 01543 450555 • Fax: 01543 450600

COPPER TUBE CRIMPING LUGS

for copper conductors

A-M



File no. E125401

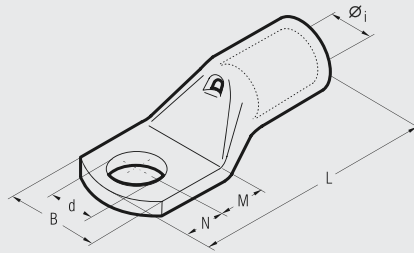

Cond. Size sqmm <small>low stranded flexible*</small>	Ø Stud mm	Ref.	Dimensions mm						Quantity Box/Bag	Mechanical Tools	Hydraulic Tools			
			Øi	B	M	N	L	d						
95	70 95	6 A 19-M 6	13,5	25,0	8,0	7,0	50,5	6,4	100/25	TN 120 SE	B 35-45D B 35-50D HT 45-E	HT 51 RH 50 B 51 B 55	HT 81-U RHU 81	HT 120 and tools and heads with 130 kN crimping force ECW-H3D RHU 520
		8 A 19-M 8	13,5	25,0	9,0	8,0	52,5	8,4	100/25					
		10 A 19-M 10	13,5	25,0	11,0	10,0	56,5	10,5	100/25					
		12 A 19-M 12	13,5	25,0	14,0	12,0	61,5	13,2	100/25					
		14 A 19-M 14	13,5	25,0	16,0	14,0	65,5	15,0	100/25					
		16 A 19-M 16	13,5	27,0	18,0	16,0	69,5	17,0	100/25					
120	95 120	20 A 19-M 20	13,5	29,5	22,0	20,0	77,5	21,0	50/25					
		8 A 24-M 8	15,2	28,5	9,0	8,0	54,0	8,4	100/25					
		10 A 24-M 10	15,2	28,5	11,0	10,0	58,0	10,5	100/25					
		12 A 24-M 12	15,2	28,5	14,0	12,0	63,0	13,2	100/25					
		14 A 24-M 14	15,2	28,5	16,0	14,0	67,0	15,0	50/25					
		16 A 24-M 16	15,2	28,5	18,0	16,0	71,0	17,0	50/25					
150	120 150	20 A 24-M 20	15,2	30,0	22,0	20,0	79,0	21,0	50/25					
		8 A 30-M 8	16,7	31,5	13,0	11,0	69,0	8,4	50/25					
		10 A 30-M 10	16,7	31,5	13,0	11,0	69,0	10,5	50/25					
		12 A 30-M 12	16,7	31,5	16,0	14,0	75,0	13,2	50/25					
		14 A 30-M 14	16,7	31,5	18,0	16,0	79,0	15,0	50/25					
		16 A 30-M 16	16,7	31,5	19,0	17,0	81,0	17,0	50/25					
185	150 185	20 A 30-M 20	16,7	31,5	22,0	20,0	87,0	21,0	50/25					
		8 A 37-M 8	19,2	35,5	13,0	11,0	76,0	8,4	50/25					
		10 A 37-M 10	19,2	35,5	13,0	11,0	76,0	10,5	40/20					
		12 A 37-M 12	19,2	35,5	16,0	14,0	82,0	13,2	40/20					
		14 A 37-M 14	19,2	35,5	18,0	16,0	86,0	15,0	30/15					
		16 A 37-M 16	19,2	35,5	19,0	17,0	88,0	17,0	30/15					
240	185 240	20 A 37-M 20	19,2	35,5	22,0	20,0	94,0	21,0	30/15					
		8 A 48-M 8	21,1	39,0	13,0	11,0	77,5	8,4	30/15					
		10 A 48-M 10	21,1	39,0	13,0	11,0	77,5	10,5	30/15					
		12 A 48-M 12	21,1	39,0	14,0	12,0	79,5	13,2	30/15					
		14 A 48-M 14	21,1	39,0	18,0	16,0	92,0	15,0	30/15					
		16 A 48-M 16	21,1	39,0	19,0	17,0	94,0	17,0	30/15					
300	240 300	20 A 48-M 20	21,1	39,0	22,0	20,0	100,0	21,0	30/15					
		10 A 60-M 10	23,7	44,0	20,0	11,0	96,0	10,5	20/10					
		12 A 60-M 12	23,7	44,0	20,0	14,0	99,0	13,2	20/10					
		14 A 60-M 14	23,7	44,0	22,0	16,0	103,0	15,0	20/10					
		16 A 60-M 16	23,7	44,0	22,0	19,0	106,0	17,0	20/10					
		20 A 60-M 20	23,7	44,0	24,0	23,0	112,0	21,0	20/10					
400	300 400	12 A 80-M 12	27,0	51,0	22,0	19,0	113,0	13,2	15/5					
		14 A 80-M 14	27,0	51,0	22,0	19,0	113,0	15,0	20/5					
		16 A 80-M 16	27,0	51,0	22,0	19,0	113,0	17,0	20/5					
		20 A 80-M 20	27,0	51,0	24,0	23,0	119,0	21,0	20/5					
		400 16 A 100-M 16	30,3	56,5	22,0	19,0	117,0	17,0	15/1					
		500 20 A 100-M 20	30,3	56,5	24,0	23,0	123,0	21,0	15/1					
630	500 630	16 A 120-M 16	33,4	61,6	22,0	19,0	128,0	17,0	12/1					
		20 A 120-M 20	33,4	61,6	24,0	23,0	134,0	21,0	10/1					
800	630	16 A 160-M 16	38,0	72,0	24,0	19,0	141,0	17,0	6/1					
		20 A 160-M 20	38,0	72,0	24,0	23,0	145,0	21,0	6/3					
1000	800	16 A 200-M 16	44,0	80,0	24,0	19,0	158,0	17,0	6/2					
		20 A 200-M 20	44,0	80,0	24,0	23,0	162,0	21,0	6/1					

*Actual conductor section may require a larger lug eg for 120mm² size use A30... lug.

WOKING

Unit 19, Woking Business Park, Albert Drive,
Woking GU21 5JY
Tel: 01483 747747 • Fax: 01483 747001

BRISTOL

The Alpha Centre, Armstrong Way, , Great Western
Business Park, Yate, Bristol BS37 5NG
Tel: 01454 322555 • Fax: 01454 323555

NORTON CANES

Unit 15-16, Bellsizes Close, Norton Canes,
Staffordshire WS11 9TQ
Tel: 01543 450555 • Fax: 01543 450600