



Heat-Shrinkable Raychem Cable Entry Seals

Watertight, Fume-Tight Cable Entry Seals for Boxes, Bulkheads,
and Other Enclosures

Heat-Shrinkable Raychem Cable Entry Seals

Watertight, Fume-Tight Cable Entry Seals



HIGH PERFORMANCE

- Strain relief
- NPT capacity
- Watertight, fume-tight cable entry seal

VERSATILE

- Metal or nylon nut
- Multi-leg breakouts
- Available in right-angle configuration
- Two basic types: standard and threaded

APPLICATIONS

- **Cable Penetration:** Panels, junction boxes and sealed cabinets
- **Bulkhead Penetration**

Heat-shrinkable cable entry seals (CES) provide a watertight, fume-tight seal where cables enter connection boxes, bulkheads, or other enclosures. CESs are available in two basic types: standard and NPT threaded.

The standard CES for thin-wall enclosures consists of a three-part assembly: a rigid nylon nut, an O-ring, and a heat-shrinkable molded body. The CES for threaded-hole applications is a one-part assembly that combines a tapered national pipe thread (NPT) in rigid nylon with a heat-shrinkable molded body. To meet sealing requirements, all CESs have factory-applied adhesive that provides the seal to wire and cable jackets.

ELECTRICAL/MECHANICAL

- **Voltage:** 600 V
- **Pressure Sealing:** 25 psi

MATERIALS

- **Molded Body:** Flame-retardant heat-shrinkable polyolefin
- **Adhesive:** Hot-melt thermoplastic
- **Nut:** Molded or nylon

STANDARDS/SPECIFICATIONS

- **Raychem RT-1335:** Cable Entry Seal Assembly
- **Raychem RT-301:** Polyolefin Molded Components
- **Raychem RW-2019:** S1297 Hot-Melt Adhesive
- **SAE AS81765/1 Type 1:** Insulating Components - Molded, Heat Shrinkable

HOT AIR HEATING TOOLS

- Raychem CV, HL, or HG Series tools

TE Components . . . TE Technology . . . TE Know-how . . .

AMP | AGASTAT | CII | HARTMAN | KILOVAC | MICRODOT | NANONICS | POLAMCO | Raychem | Rochester | DEUTSCH
SEACON Phoenix | LL ROWE | Phoenix Optix | AFP | SEACON

Get your product to market faster with a smarter, better solution.

Product Dimensions

Standard CES
Dimensions are
mm (inches)

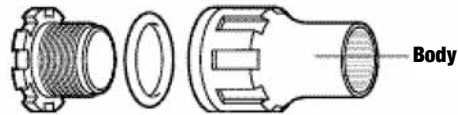

Part No.	No. of Legs	Overall Nom. Recommended Length	Min. Expanded ID Body	Max. Recovered ID Body	Max. ID of Part	Drill Size	Max. OD of Nut
CES-1	1	69.85 (2.75)	12.70 (0.50)	4.32 (0.17)	19.05 (0.75)	25.40 (1.00)	35.81 (1.410)
CES-2	1	69.85 (2.75)	19.05 (0.75)	6.35 (0.25)	19.05 (0.75)	25.40 (1.00)	35.81 (1.410)
CES-3	1	95.25 (3.75)	28.45 (1.12)	12.70 (0.50)	27.94 (1.10)	35.05 (1.38)	48.31 (1.902)
CES-4	1	114.30 (4.50)	40.64 (1.60)	19.05 (0.75)	39.62 (1.56)	50.80 (2.00)	69.09 (2.720)
CES-5	1	177.80 (7.00)	69.85 (2.75)	36.32 (1.43)	73.66 (2.90)	88.90 (3.50)	103.38 (4.070)

Part configuration may be different than depicted in figure. Contact TE for specification.

Breakout CES
Dimensions are
mm (inches)

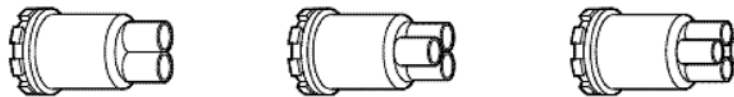

Part No.	No. of Legs	Overall Nom. Recommended Length	Min. Expanded ID (Each Leg)	Max. Recovered ID (Each Leg)	Max. ID of Part	Drill Size	Max. OD of Nut
CES-2-D1A	2	69.85 (2.75)	15.24 (0.60)	2.79 (0.11)	19.05 (0.75)	25.40 (1.00)	35.81 (1.41)
CES-2-T1	3	69.85 (2.75)	10.16 (0.40)	2.79 (0.11)	19.05 (0.75)	25.40 (1.00)	35.81 (1.41)
CES-2-T1B	3	88.90 (3.50)	15.24 (0.60)	4.32 (0.17)	19.05 (0.75)	25.40 (1.00)	35.81 (1.41)
CES-2-F1A	4	69.85 (2.75)	10.16 (0.40)	2.79 (0.11)	19.05 (0.75)	25.40 (1.00)	35.81 (1.41)
CES-2-F1	4	88.90 (3.50)	15.24 (0.60)	4.32 (0.17)	19.05 (0.75)	25.40 (1.00)	35.81 (1.41)
CES-3-D1	2	88.90 (3.50)	15.24 (0.60)	4.32 (0.17)	27.94 (1.10)	35.05 (1.38)	48.26 (1.90)
CES-3-T1	3	88.90 (3.50)	15.24 (0.60)	4.32 (0.17)	27.94 (1.10)	35.05 (1.38)	48.26 (1.90)
CES-3-F1	4	88.90 (3.50)	15.24 (0.60)	4.32 (0.17)	27.94 (1.10)	35.05 (1.38)	48.26 (1.90)
CES-4-D3	2	101.60 (4.00)	22.86 (0.90)	7.62 (0.30)	40.64 (1.60)	50.80 (2.00)	69.09 (2.72)
CES-4-T1	3	101.60 (4.00)	22.86 (0.90)	7.62 (0.30)	40.64 (1.60)	50.80 (2.00)	69.09 (2.72)
CES-4-F1	4	101.60 (4.00)	22.86 (0.90)	7.62 (0.30)	40.64 (1.60)	50.80 (2.00)	69.09 (2.72)
CES-5-T4	3	127.00 (5.00)	31.75 (1.25)	12.70 (0.50)	73.66 (2.90)	63.50 (2.50)	103.38 (4.07)
CES-5-F4	4	127.00 (5.00)	31.75 (1.25)	12.70 (0.50)	73.66 (2.90)	63.50 (2.50)	103.38 (4.07)

Right-Angle
Breakout CES
Dimensions are
mm (inches)

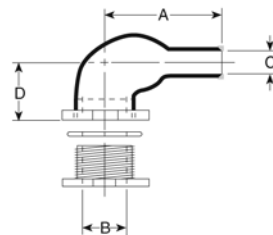

Part No.	C		B ID Min	Length		Drill Size
	Min. Exp. ID	Max. Rec. ID		D	A	
CES-1R	12.70 (0.50)	7.11 (0.28)	12.70 (0.50)	35.56 (1.4)	42.67 (1.68)	25.40 (1.00)
CES-2R	18.03 (0.71)	8.38 (0.33)	19.05 (0.75)	43.18 (1.7)	44.96 (1.77)	25.40 (1.00)
CES-3R	27.94 (1.10)	9.65 (0.38)	27.94 (1.10)	53.34 (2.1)	58.42 (2.30)	34.80 (1.37)
CES-4R	40.64 (1.60)	15.75 (0.62)	40.64 (1.60)	78.74 (3.1)	71.12 (2.80)	50.80 (2.00)

LET'S CONNECT

We make it easy to connect with our experts and are ready to provide all the support you need. Just call your local support number or visit www.te.com/industrial to chat with a Product Information Specialist.

Technical Support

te.com/support-center

North America	+1 800 522 6752	Asia Pacific	+86 400 820 6015
North America (Toll)	+1 717 986 7777	Japan	+81 044 844 8180
EMEA/South Africa	+800 0440 5100	Australia	+61 2 9554 2695
EMEA (Toll)	+31 73 624 6999	New Zealand	+64 (0) 9 634 4580
India (Toll-Free)	+800 440 5100		

te.com/harnessrepair

AMP, AGASTAT, CII, DEUTSCH, HARTMAN, KILOVAC, LL ROWE, MICRODOT, NANONICS, POLAMCO, Raychem, SEACON, TE, TE Connectivity and the TE connectivity (logo) are trademarks of the TE Connectivity Ltd. family of companies. Other products, logos, and company names mentioned herein may be trademarks of their respective owners.

While TE Connectivity (TE) has made every reasonable effort to ensure the accuracy of the information herein, nothing herein constitutes any guarantee that such information is error-free, or any other representation, warranty or guarantee that the information is accurate, correct, reliable or current. The TE entity issuing this publication reserves the right to make any adjustments to the information contained herein at any time without notice. All implied warranties regarding the information contained herein, including, but not limited to, any implied warranties of merchantability or fitness for a particular purpose are expressly disclaimed. The dimensions herein are for reference purposes only and are subject to change without notice. Specifications are subject to change without notice.

Consult TE for the latest dimensions and design specifications.

© 2017 TE Connectivity Ltd. family of companies All Rights Reserved.

1-1773456-0 01/17