

Multi Service Distribution Board

J type vertical 15, 24, 30 way, 1 and 2 J, 630A rated

Overview and presentation

Mild steel wall mounting distribution boards for 3 phase systems configurable with either a single incoming bank of triple pole J type slotted tag fuses or with an additional outgoing bank of triple pole J type fuses for mixed developments requiring a split supply greater than 100A.



1 J version (LH supply)



1 J version (RH supply)

Features

- Multi-tier outgoing fuse ways provide increased space for cabling
- Factory options include:
 - Left or right-hand incoming supply
 - Single or twin bank of triple pole J type fuse links
 - 4 core incoming / outgoing cable kit
 - N/E bar located at top or bottom of enclosure to suit top or bottom entry options
- Site configurable for CNE or SNE cable systems
- M12 fixings for incoming connections and internal busbar links
- Pre-drilled removable gland plate fitted with closed cell foam sealing gasket
- Removable double doors to facilitate fitment in shallow riser cupboards
- Accept up to 300mm² 3 or 4 core aluminium or copper conductors
- Optional glanding kit for different cable types e.g. copper screened, aluminium or steel wire armoured

Note: The equipment described on this data sheet must be installed by suitably qualified personnel according to applicable local / national wiring regulations currently in force.

Enclosure specification

- Oven-cured epoxy powder coated finish with a minimum thickness of 50 microns
- Standard colour admiralty grey to BS 381c, shade no 632
- Two stage padlockable double doors enabling independent access to outgoing 100A fuse ways or Distribution Network Operator (DNO) access to incoming J type fuses
- Quick release spring loaded hinge pins permit rapid door removal for improved access
- Overall 250mm depth enables installation in confined spaces
- Two external M12 earth studs

Internal equipment

- Operator protection IP2XB (all screens, shrouds and fuse handles in place)
- Equipped with BS 7657 100A rated SP outgoing ways (BS 88 30 x 57mm cylindrical cartridge fuses, not supplied)
- Serrated cable bores in 100A outgoing ways accept up to 35mm² solid or stranded conductors
- Neutral and Earth bars fitted with twin hexagon drive M8 cable pinching screws per terminal
- Termination kit for 4 core cable with 95mm² to 300mm² mechanical shear-off connectors specifiable at point of order
- Above terminals will accept solid aluminium or stranded copper conductors, Waveform or SWA type cables (additional kit required for each SWA termination)
- BS 88 J type slotted tag fuses with 92mm fixing centres fitted on incoming phases
- Fully rated neutral and earth bars
- 1J Ex works net weight

Internal equipment

- Fully rated neutral and earth bars
- 3 x BS 88 J type 92mm centre fuse handles per TP way

Construction

- Enclosure.....zinc coated mild steel 1.2mm thick
- Busbars.....electro-tin plated copper
- Terminal blocks brass
- Terminal shields..... transparent polycarbonate
- J type fuse holders.....glass reinforced polybutylene terephthalate (PTB)
- J type fuse bases glass reinforced polyamide 6

Performance data

- Incoming supply630A max
- Busbar rating630 A nominal
- Supply voltage 415V a.c.
- Frequency50-60Hz
- Rated insulation voltage.....690V a.c.
- Short circuit withstand strength18kA for 1 second

Operator protection

- All shrouds and fuse handles in place IP2XB

Operational condition

- All shrouds and fuse handles in place IP2XB
- Operational condition, both doors closed.....IP3X
- Recommended N/E bar terminal torque3.5Nm

Conformity to standards

- Third party tested to BS EN 60439-1 (form 4 compliant)
- Complies with draft ENA technical specifications for MSDBs
- IP rating according to BS EN 60529
- Incoming fusesBS 88 J type
- Outgoing fuse ways to BS 7657:1993

Weights (excluding fuses)

15 way

- 1J Ex works net weight44kgs
- 2J Ex works net weight58kgs

24 way

- 1J Ex works net weight53kgs
- 2J Ex works net weight69kgs

30 way

- 1J Ex works net weight60kgs
- 2J Ex works net weight76kgs

1J enclosure (not to scale)

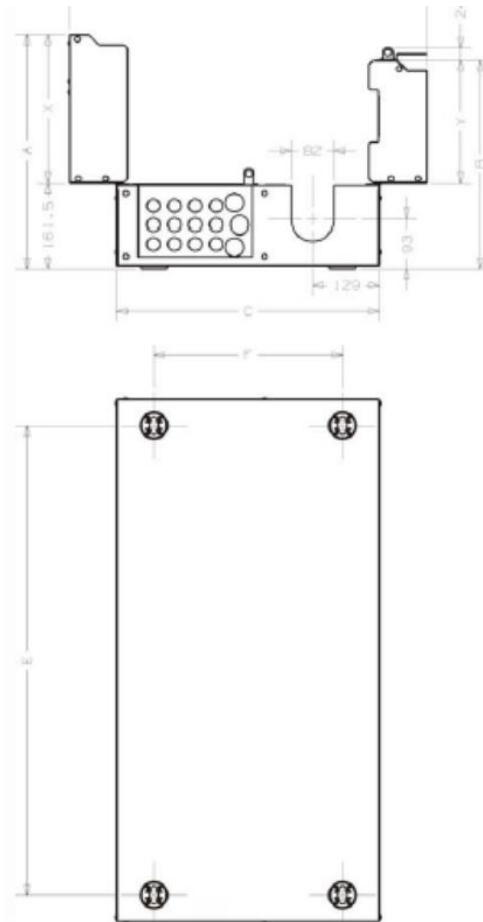

Height: 1000mm, case closed depth: 248mm

Configuration	Dimensions in mm						Fixing centres	
	X	Y	C	D	A	B	E	F
15 way 1J	285	235	503	685	447	397	900	299
24 way 1J	424	235	642	825	586	397	900	500
30 way 1J	517	235	735	918	697	397	900	537

Disclaimer

Lucy Switchgear has a policy of continuous research and development and accordingly reserves the right to change the design and specifications of its products without prior notice or liability.

www.lucyelectric.com
engineering intelligent solutions

2J enclosure (not to scale)

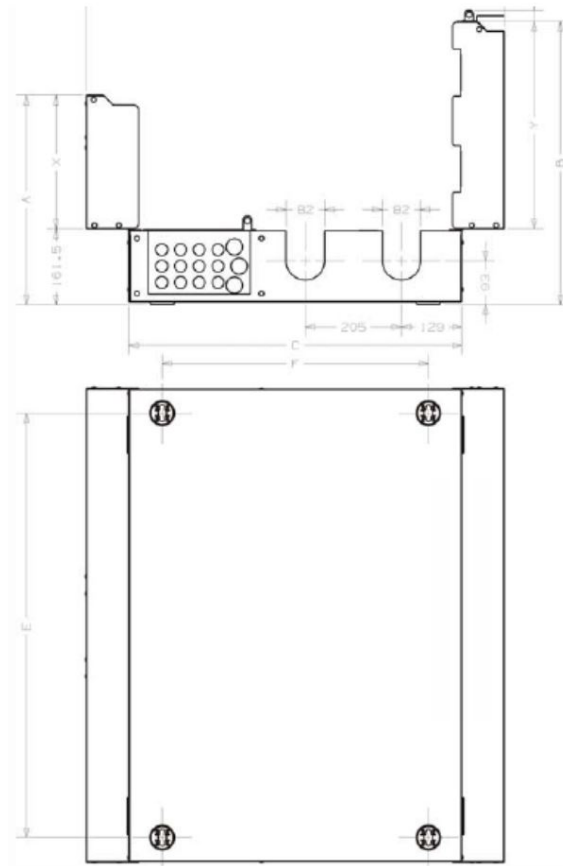

Height: 1000mm, case closed depth: 248mm

Configuration	Dimensions in mm						Fixing centres	
	X	Y	C	D	A	B	E	F
15 way 2J	285	422	710	893	447	604	900	537
24 way 2J	424	442	849	1032	586	604	900	661
30 way 2J	517	442	942	1125	679	604	900	769

Disclaimer

Lucy Switchgear has a policy of continuous research and development and accordingly reserves the right to change the design and specifications of its products without prior notice or liability.

www.lucyelectric.com
engineering intelligent solutions